

# APPENDIX 'A'

## Sample Site Plan

### POOL REGULATIONS

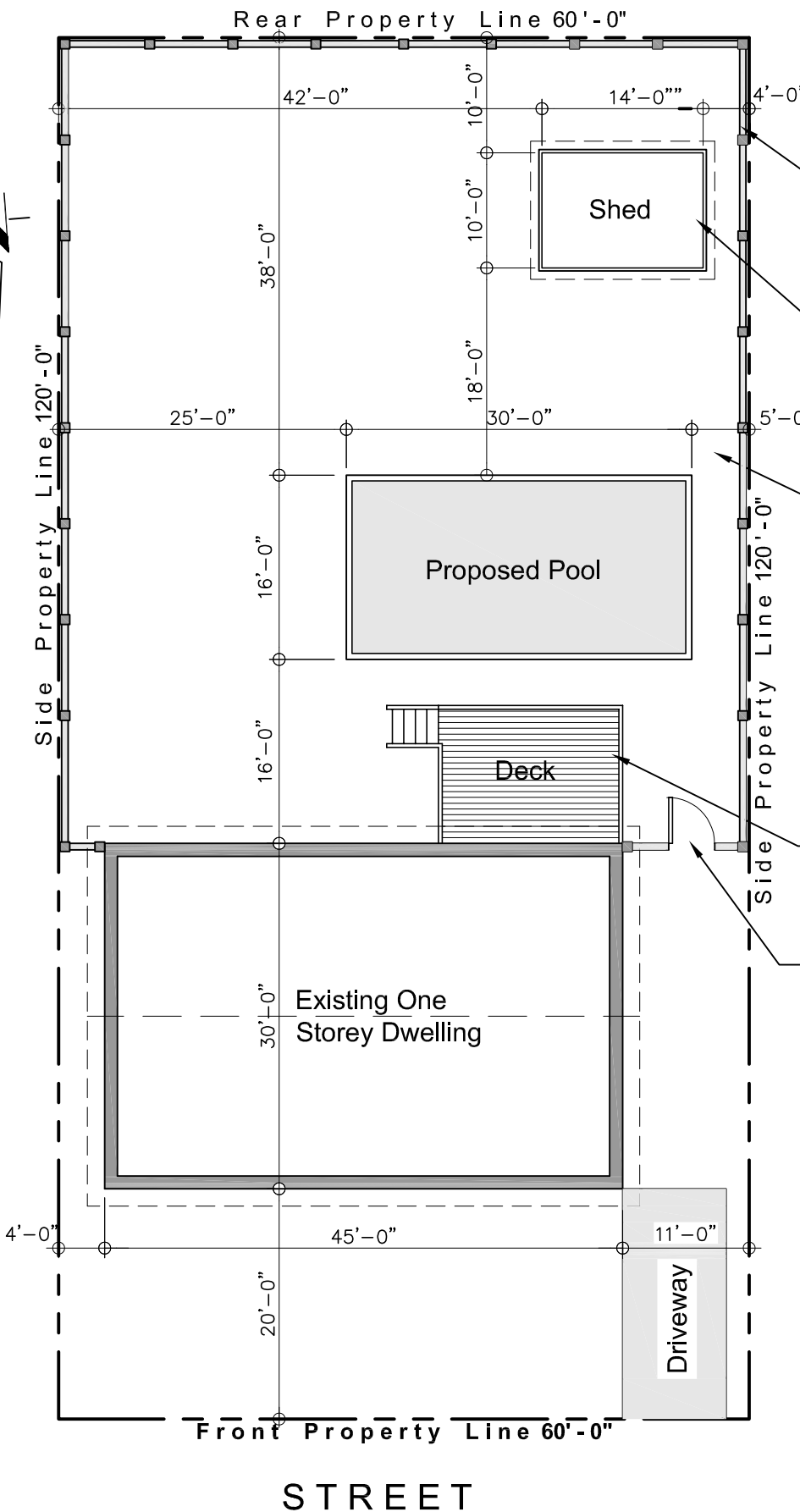

Proposed WOOD FENCE (4' min., 6'-6" max.) at PROPERTY LINE. Fence may be located away from PROPERTY LINE but must be located on the subject property.

Buildings Accessory to the Proposed Pool must be shown on the site plan and their location must conform to the appropriate Zoning By-Law. Any Buildings larger than 108 sq.ft. requires a Building Permit.

All POOLS and Pool Equipment must be located at least 5'-0" from any INTERIOR LOT LINE and are not permitted within any required EXTERIOR YARD as defined in the appropriate Zoning By-Law.

**Note:**

A swimming pool enclosure must surround or enclose the entire Swimming Pool Area except when the vertical walls of an Above Ground Swimming Pool has a height of not less than 52" [4'-4"]

Associated DECKS may require a Building Permit as per the City of Greater Sudbury and the Ontario Building Codes policy on DECKS.

All GATES within the Pool Enclosure must be at least 4'-0" high and must be equipped with Self-Closing, Self-Latching and Locking Devices located at least 42" above Enclosure and mounted on the pool side of the Gate.

**REQUIREMENTS FOR POOL ENCLOSURE(FENCES)**

- Minimum Height of Fences 4'-0"
- Maximum Height of Solid Fences 6'-6"
- All fences shall be constructed in a manner that will prevent climbing from the outside of the pool enclosure.
- Chain link fencing is permitted only if the Openings in the mesh are NOT more than 1½" (38mm) in size.
- Refer to Appendix 'E' & 'F' for typical Pool Enclosures

**Note:**

- 1.) Do Not Submit this Sample Drawing as part of your Drawing Package.
- 2.) Plans Submitted for Review are to be drawn at a Recognized Scale ie. 1"= 20'-0" or 1:100(metric)

# APPENDIX 'B'

**NOTE:**

Above Ground Pool Fence can be added as an Option when pool wall is less than 4'-4" high.

or

Install a Pool Enclosure. Refer to Appendix 'E' & 'F' for typical Pool Enclosures

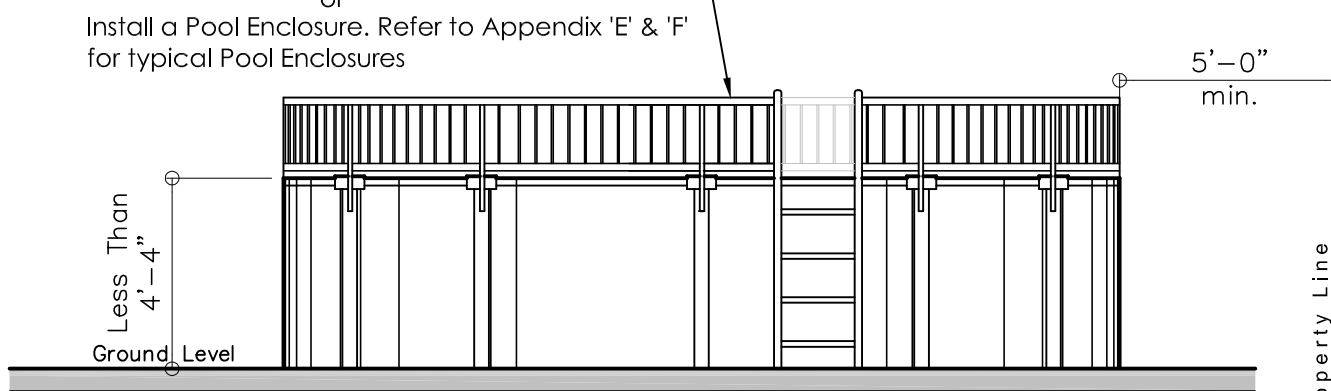

Vertical Walls Less Than 4'-4"

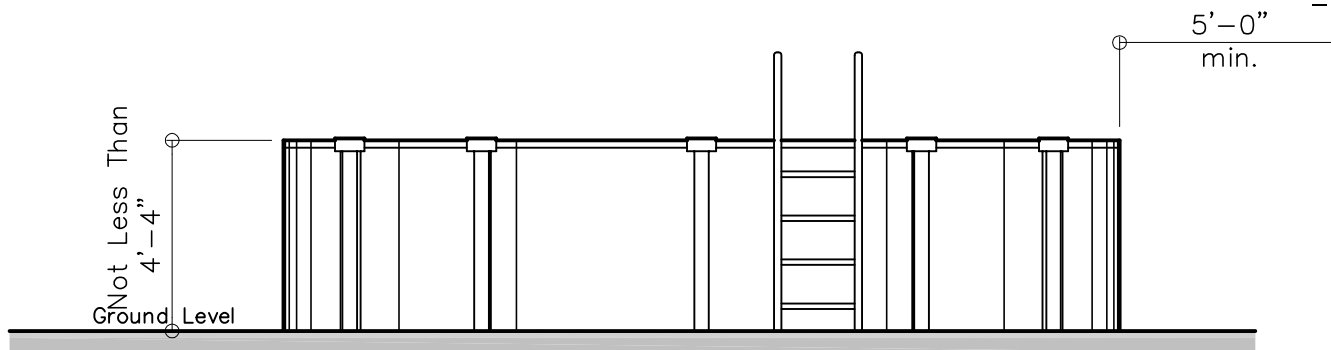

Vertical Walls Not Less Than 4'-4"

All POOLS and Pool Equipment must be located at least 5'-0" from any INTERIOR LOT LINE and are not permitted within any EXTERIOR YARD as defined in the appropriate Zoning By-Law.

**NOTES:**

A swimming pool enclosure must surround or enclose the entire Swimming Pool Area except when the vertical walls of an Above Ground Swimming Pool has a height of not less than 52"(1.32m)[4'-4"].

The wall of the Above Ground Pool shall not possess any Horizontal members that may facilitate climbing.

No pool equipment, pump, filter or other equipment, object or material is attached or placed or piled within 3' (0.91m) of the Above Ground Swimming Pool so as to facilitate climbing or diminish the structural integrity of the walls.

Any steps, ladder or other means of entry to the Above Ground Pool shall be removed or have a lockable closing mechanism or in the alternative, a gate to prevent access to pool when the owner is not present.

Up to 2' (0.61m) of water may be added to an Above Ground Pool for the purpose of maintaining structural integrity prior to the inspection and approval.

# APPENDIX 'C'

## REQUIREMENTS FOR POOL ENCLOSURE(FENCES)

- Minimum Height of Fences 4'-0"
  - Maximum Height of Solid Fences 6'-6"
  - All fences shall be constructed in a manner that will prevent climbing from the outside of the pool enclosure.
  - Chain link fencing is permitted only if the Openings in the mesh are less than 1½" in size.
- All GATES within the Pool Enclosure must be at least 4'-0" high and must be equipped with Self-Closing, Self-Latching and Locking Devices located at least 42" above the bottom of enclosure and mounted on the pool side of the gate.

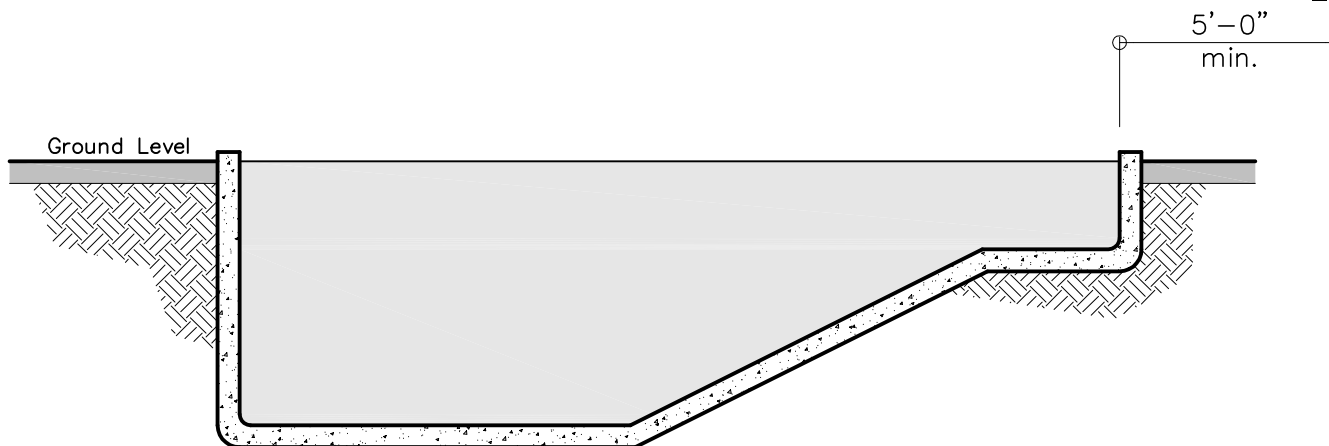

All POOLS and Pool Equipment must be located at least 5'-0" from any INTERIOR LOT LINE and are not permitted within any EXTERIOR YARD as defined in the appropriate Zoning By-Law.

### NOTES:

A swimming pool enclosure must surround or enclose the entire Swimming Pool Area. Refer to Appendix 'E' & 'F' for typical Pool Enclosures

Foliage or a Vegetative Barrier (ie. cedar hedge) Does Not meet the requirements of a Swimming Pool Enclosure.

### NOTE:

Unless and until a Swimming Pool Enclosure has been fully erected and inspected, every person erecting an Inground Outdoor Swimming Pool shall erect a Temporary Enclosure so as to completely enclose the construction area. The Temporary Enclosure shall consist of 3'-6" (1.07m) high plastic mesh fence having mesh openings not greater than 2" (50mm) and supported by steel T-bar posts located a maximum 7'-10" (2.4m) apart with nine (9) gauge galvanized steel wire located at top & bottom of such fence or is constructed of material that will provide an equivalent or greater degree of safety and has been approved in advance by the Chief Building Official.

# APPENDIX 'D'

## NOTE:

Additional Structural support should be added to Decks supporting Private Spas or Hot Tubs. Weight can be in excess of 5,000 lbs which includes water and Occupants.

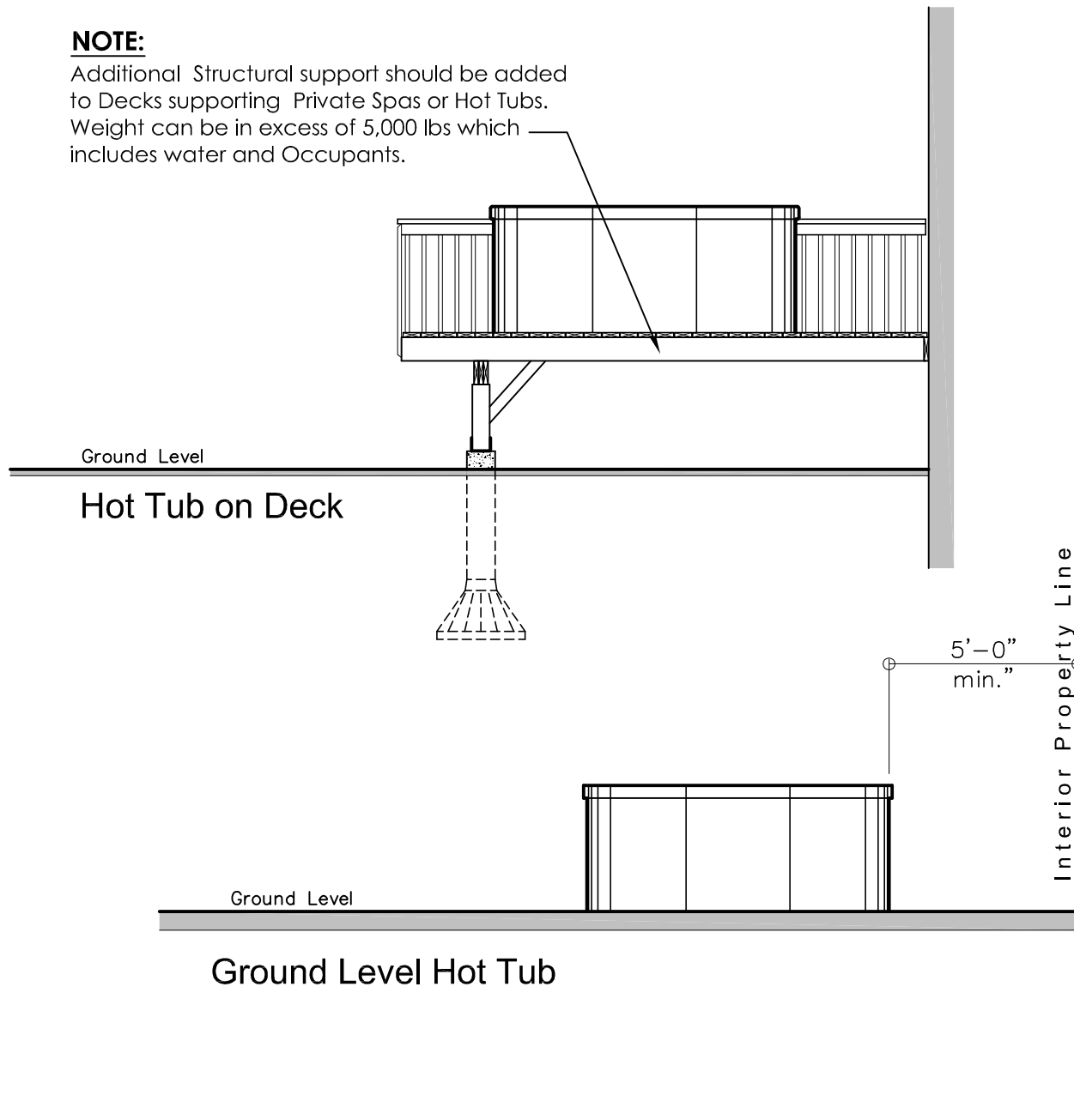

A Private Spa or Hot Tub must be located at least 5'-0" from any INTERIOR LOT LINE and are not permitted within any EXTERIOR YARD as defined in the appropriate Zoning By-Law.

## NOTES:

A Private Spa or Hot Tub is deemed to be an Outdoor Swimming Pool unless, the Private Spa or Hot Tub has a safety cover which is a substantial, structurally adequate cover that is capable of supporting a 200 lbs (90 kilogram) load and is in compliance with the current American Society for Testing and Materials standard ASTM-F-1346 for Hot Tub and pool safety covers.

The safety cover is permanently attached to the Private Spa or Hot Tub or to its supporting structure.

The Owner shall ensure the safety cover is securely fastened and locked so as to prevent access at all times when the Private Spa or Hot Tub is not in use.

## NOTES:

If safety cover is NOT securely fastened and locked a Pool Enclosure must be installed.

A swimming pool enclosure must surround or enclose the entire Swimming Pool Area. Refer to Appendix 'E' & 'F' for typical Pool Enclosures

Foliage or a Vegetative Barrier (ie. cedar hedge) Does Not meet the requirements of a Swimming Pool Enclosure.

**NOTE:**

All GATES within the Pool Enclosure must be at least 4'-0" high and must be equipped with Self-Closing, Self-Latching and Locking Devices located at least 42" above the bottom of the enclosure and mounted on the pool side of the gate.

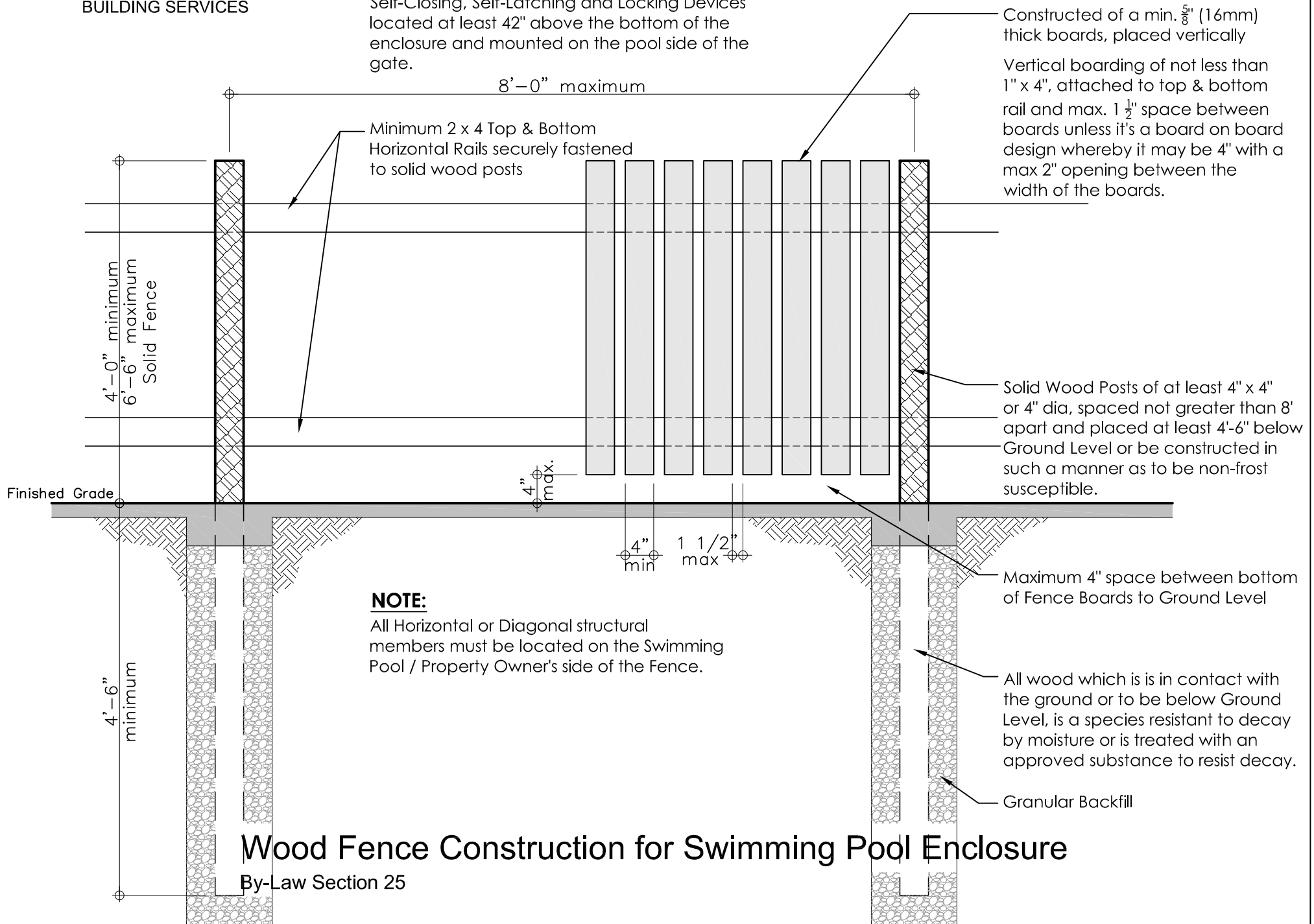

**NOTE:**

All Horizontal or Diagonal structural members must be located on the Swimming Pool / Property Owner's side of the Fence.

**Wood Fence Construction for Swimming Pool Enclosure**

By-Law Section 25

