

April 27, 2023

## Pavement Rehabilitation Panache Lake Road, Whitefish

The City of Greater Sudbury is planning **road improvements** on **Panache Lake Road**, between MR 55 and St. Pothier Road, in Whitefish.

The City of Greater Sudbury is planning **road improvements** on **Panache Lake Road, Whitefish**, between **MR 55 to St. Pothier Road**. This project is part of the Council-approved 2023 Capital Works Program to renew our aging infrastructure and improve drainage.

**Project Highlights:**

- Pavement Rehabilitation
- Introduction of Paved Shoulders
- Rock Removal
- Culvert Replacements and Drainage Improvements

**Expected Start Date:** Summer 2023

**Expected End Date:** Spring 2024

**\*Timeline is subject to change\***

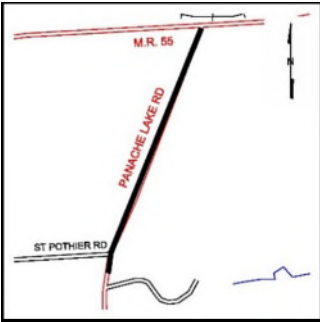

For more information, please visit [www.greatersudbury.ca/construction2023](http://www.greatersudbury.ca/construction2023). If you do not have access to the website, please contact the Project Team members listed below and a package with further project details can be mailed to you.

**Questions about upcoming construction can be directed to:**

**Project Manager:**

Andrew Peltomaki  
705-674-4455, extension 4392  
705-690-5541

[Andrew.Peltomaki@greatersudbury.ca](mailto:Andrew.Peltomaki@greatersudbury.ca)

**Project Designer:**

Joey Crispo  
705-674-4455 extension 4332  
[Joey.Crispo@greatersudbury.ca](mailto:Joey.Crispo@greatersudbury.ca)



**Before Construction Begins:**

- Work crews will mark the locations of underground utilities, such as gas, water and cable so that the construction work does not interfere with these utilities.
- Once a Contractor has been selected, affected property owners will receive a construction notice with more information about the work.
- Property owners should redirect to above ground, any roof drains and/or sump pump outlets that currently discharge into the front ditch.
- **The City is not responsible for damage to any privately-owned items on the municipal right-of-way.** Property owners should remove items located within the municipal right-of-way, such as landscaping, fencing, sprinkler systems and decorative objects.
- Once Panache Lake Road has been repaved with new asphalt, roadway cuts to install new utilities will not be permitted for a period of three (3) years. Therefore, you should contact your hydro, gas, telephone or cable providers should you require changes to these services as well as notify the Project Manager.
- Should you wish to make any modifications to your property entrance **or replace an existing culvert**, please contact the Project Manager listed below prior to June 5, 2023.
- Blasting is required as part of the construction, you will be contacted regarding a pre-blast survey of your home to be completed prior to blasting operations commencing. The pre-blast survey is conducted by a third-party consultant and is a visual inspection of your home and other structures complete with photos and/or video. The consultant will be required to enter the home to complete the interior portion of the survey. Rock removal operations may close the road for up to twenty (20) minutes.
- If we need to contact you regarding further impacts to your property, the Project Manager will reach out with a further notice.