

Construction NOTICE



Dufferin Street, Sudbury Watermain Lining

The City of Greater Sudbury will be completing **watermain improvements** on **Dufferin Street, Sudbury**, between **Beatty Street** and **80m East of Beatty Street**.

Construction by the City's contractor, Fer-Pal Construction Limited, will be carried out between **July 2022 and November 2022**.

Work will take place Monday to Friday, between 7:00 a.m. and 7:00 p.m.

Final asphalt will be completed by November 2022.

Please note these timelines are subject to change.

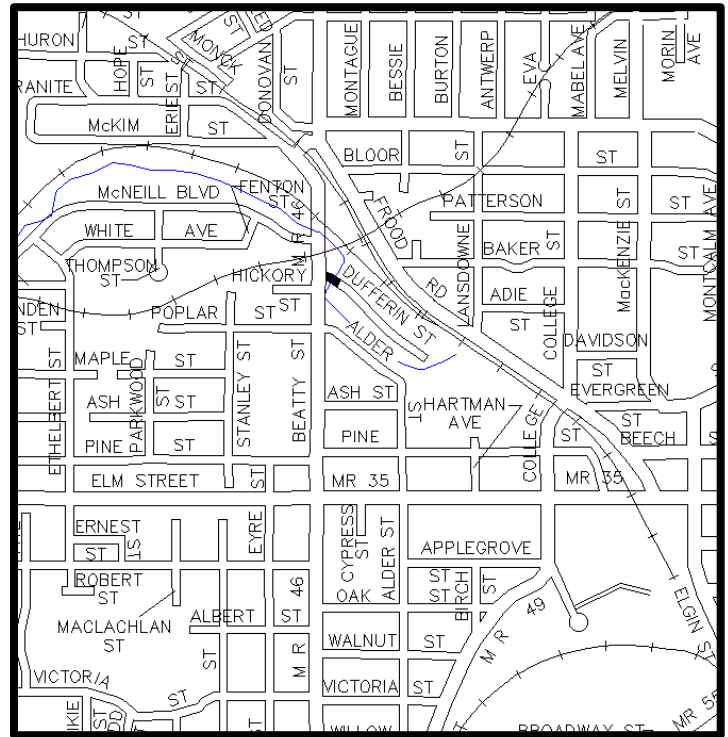

Construction Details:

- **Install temporary above-ground water supply system**
- **Watermain lining**
- **Restoration to affected areas**

During construction, there may be dust and noise in the area. The City makes every effort to reduce the impact to nearby residents and business owners. Thank you for your patience as we work to improve the roads and infrastructure in your neighbourhood. The City of Greater Sudbury and its contractors are committed to public safety and will monitor the ongoing progress of construction.

Questions about construction can be directed to:

Project Manager:

Marc Khoury

705-674-4455, extension 4446







marc.khoury@greatersudbury.ca

Field Inspector:

Joseph Eadie

705-919-3263

joseph.eadie@greatersudbury.ca

	<p>Before Construction Begins:</p> <ul style="list-style-type: none"> Property owners should remove items located within the municipal right-of-way, such as landscaping, fencing, sprinkler systems and decorative objects. Property owners should redirect to above ground, any roof drains and /or sump pump outlets that currently discharge into the front ditch. The City is not responsible for damage to any privately-owned items on the municipal right-of-way.
	<p>Temporary Water Service Supply:</p> <ul style="list-style-type: none"> Homes in the construction area will be connected to a temporary water supply system. You will continue to receive municipal water service while work is underway. The temporary system connects your outdoor water faucet to a hose that is specially designed for potable drinking water. It's very important not to disconnect or turn off your outdoor faucet while this temporary water supply system is in place. Your water consumption will not be metered while receiving water from the temporary supply system. Instead, your bill will be based on a monthly average. Please note that the City's contractor, Fer-Pal Construction Limited, may need to access your property or residence to connect this temporary water supply system. If you are not home, a business card will be left at your residence. Please call the number to arrange an appointment. You can expect two brief water service interruptions: one to connect the temporary water supply system, and a second to connect the new watermain once the work is complete. You will be notified in advance of any water service interruptions.
	<p>Traffic:</p> <p>Plans are in place to manage traffic in the area to ensure the safety of workers and residents. You may experience some delays and increased traffic on nearby main and side streets. At times, your street may be reduced to one lane of traffic to accommodate construction.</p>
	<p>Driveway Access:</p> <p>If temporary driveway closures are required, the contractor will provide notice to the affected properties and make arrangements for alternative access and parking when necessary. Entrances to businesses and public institutions shall remain accessible at all times.</p>
	<p>Road and Sidewalk Access:</p> <p>Safe access for pedestrians will be maintained. Parents are reminded to teach children about road safety in active construction zone areas. Residents who have accessibility needs, such as wheelchair access, are asked to contact the City Field Inspector or Project Manager listed on this notice.</p>
	<p>Emergency Services and Public Transit:</p> <p>Access for police, fire and paramedic services vehicles will be maintained at all times. Public transit detours may occur during construction. Please call GOVA at 705-675-3333 or visit www.greatersudbury.ca/gova/ for information. Should the work affect the school bus route, the Sudbury Student Services Consortium will inform you of any changes to the scheduled route.</p>
	<p>Garbage Collection:</p> <p>Garbage, recycling, and leaf and yard trimmings pickup will not be affected by construction. Please place your waste at the front of your property before 7 a.m. on your regular collection day. If waste collection vehicles are unable to access properties in the construction area, the contractor will transport the waste outside of the zone for pickup. Your garbage, recycling and organics containers will be returned to your property later in the day. Please ensure your containers are labeled with your address so that they can be returned to you.</p>